

# DA 1911 Flange Inlet

## Technical Info

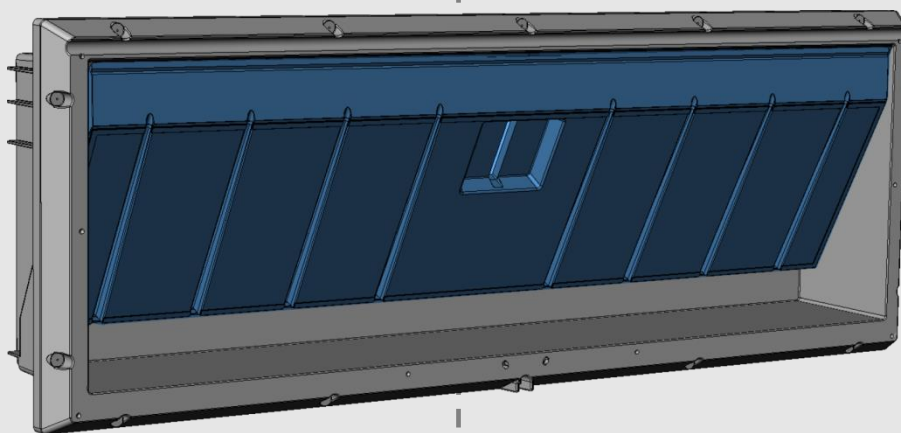

## 1 Product description

Flange inlet DA 1911 is a universal wall inlet which is used for ventilating livestock houses with natural, LPV or Combi-Tunnel ventilation.

The flange inlet can be adapted to a wall thickness up to 50cm by means of an extension piece. The inlet is fixed on the inside wall by screws through the flange itself. It cannot be built or cast directly into wall elements.

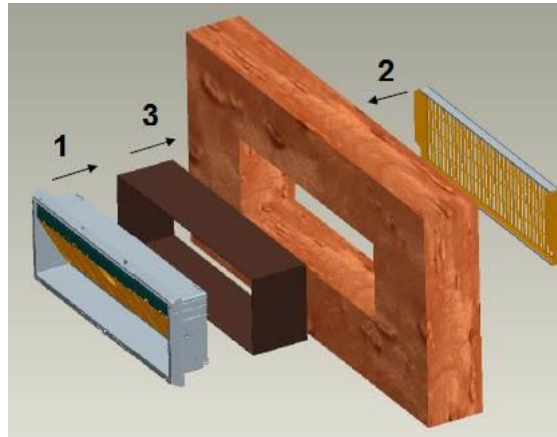

The universal differentiation of the inlets is patent pending and is supplied with a regulation set which makes it easy to adjust the air inlet in accordance with the current conditions.

### Accessories

The coarse mesh is an accessory to avoid penetration of birds and larger animals. Furthermore, the following are available: an air direction baffle optimizing the air distribution in the house in periods with cold weather conditions and a wind shield for livestock houses exposed to special wind conditions.

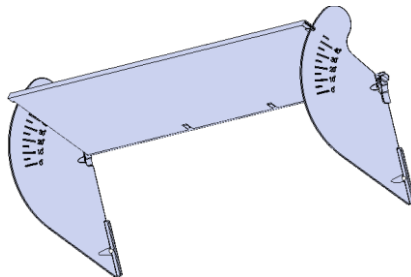

### Functional description

Opening the inlet flap "downwards", it directs the cold fresh air in an upward moving direction. Here the fresh air is mixed with the warm air inside the livestock house before reaching the animal zone. In case of hot weather conditions, the inlet will be in a fully open position.

DA 1911 is easy-to-clean due to its open and smooth construction. Also, the thermoplastic stands high-pressure cleaning. Furthermore, the choice of material makes the inlet resistant to UV radiation. The inlet is made of high-impact material; it is dimensionally stable and 100% recyclable.

## 2 Product survey

### DA 1911 flange inlet

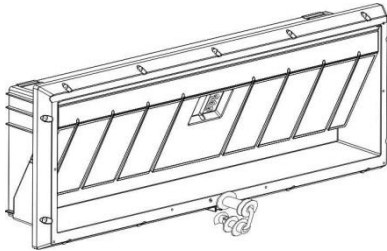

**433161 DA 1911 flange inlet 11cm**

**433130 DA 1911 flange inletl w. transp. flap**

**433169 DA 1911 flange inlet, 11cm, coarse mesh**

The flange inlet is supplied with or without coarse net. In addition, there is a variant with a transparent flap.

The inlet shutter is insulated, and the springs are made of stainless steel.

The flange inlet is supplied with regulation set and part for Advanced Inlet Control.

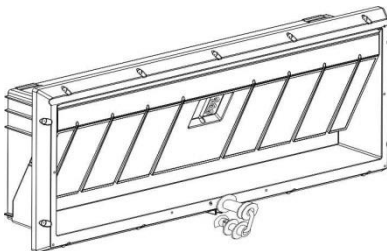

**433131 DA 1911 HP flange inlet 11cm coarse net**

The flange inlet is supplied with coarse net and reinforced springs.

The inlet shutter is insulated, and the springs are made of stainless steel.

The flange inlet is supplied with regulation set and part for Advanced Inlet Control.

Used if the flange inlets are to be closed at a negative pressure between 65 Pa and 80 Pa.

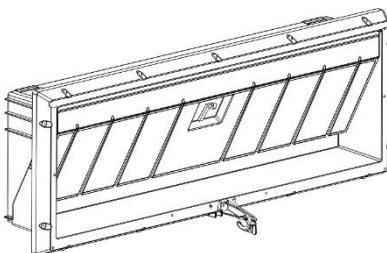

**433165 DA 1911B flange inlet 11 cm**

Advanced Inlet Control is not possible for DA 1911B.

The inlet flap is not insulated, and the springs are electroplated.

The flange inlet is supplied with regulation kit.

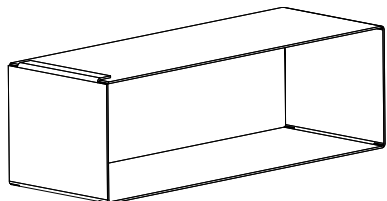

**433166 DA 1911 extension piece 20cm**

Used for wall dimensions from 12 to 28cm.

**433167 DA 1911 extension piece 30 cm**

Used for wall dimensions from 17 to 38 cm.

**433168 DA 1911 extension piece 40 cm**

Used for wall dimensions from 22 to 49 cm.

DA 1911 extension must be used together with the flange inlet when the wall thickness exceeds 11cm.



**433164 DA 1911 mesh, coarse 65x20mm**

It is used to avoid ingress of birds and larger animals.

Click it directly onto the inlet and outside flange.

One per inlet.

## DA 1911 flange inlet



### 433117 – DA 1211/1911 net holder set for 25 inlets

The inlet net holder is used to mount the mesh (433164) when mounting on the outer wall instead of directly on the inlet, for example, if window openings are deep.

Includes 100 holders.

1 set per 25 inlets.



### 433043 DA 1211/1911 screw kit f. flange, 10/5 set

Used for mounting of DA 1911 flange inlet. Includes 40 4.8x70mm tapping screws.

One set for each five inlets.



### 433025 DA 1200/1900 screw kit f. net

Is used for fastening of mesh in connection with extension on DA 1911 inlets. Includes the required number of 5 x 30mm stainless screws.

One set for each six inlets.

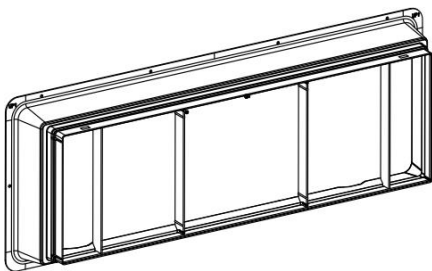

### 433137 DA 1911 outside flange

Outside flange is used to make a nicer finish on the outside of the building and the inlet funnel can subsequently be mounted on the flange

One per inlet.

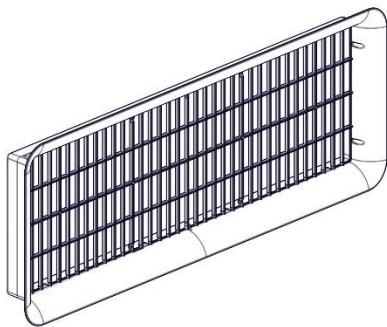

### 433136 DA 1911 inlet funnel

Inlet funnel is used to improve performance by up to 22% as well as avoid the ingress of birds and larger animals.

Click it directly onto the inlet and outside flange.

One per inlet.

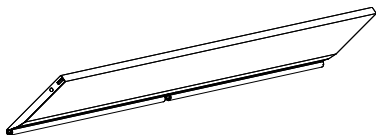

### 433173 DA 1911 air direction baffle, short

DA 1911 air direction baffle is used to adjust the air jet under cold weather conditions and to avoid adhesion on the wall.

One per inlet.

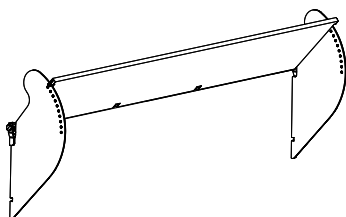

### 433172 DA 1911 air direction baffle, long w. side plates

DA 1911 air direction baffle is used to adjust the air jet under cold weather conditions and to avoid adhesion on the wall.

Long air direction baffle is mounted with side plates.

One per inlet.

## DA 1911 flange inlet



### 560195 DA 1200 operation set w. long U-shackle

Used where obstacles such as lopsided walls, steel trusses projecting up to 70mm out from the wall, etc. impede the free movement of the pull rod. The current system of differentiation can not be used with the kit and therefore an extra string with spring to reduce the slack is included by which you can make differentiation.

The inlet flap should as a maximum open to a horizontal position; otherwise it may overload the winch motor.

One per inlet.



### 433039 DA 1200 extension piece 240mm

### S433037B DA 1200 extension piece 400mm, type B

Extension rod is used if you want to carry the pull rod round heavy concrete pillars or the like where it is not possible to carry the pull rod directly through the pillar by making a through-going hole. The extension rod is made of stainless steel.

One per inlet.



### 401349 All-purpose holder for pull rod

Is used for flange inlets and built-in inlets.

If there are more than approx. 2 m between the inlets, the pull rod will bend downwards causing inaccuracy if all-purpose holders are not used.

1 unit by every 2 m free hanging pull rod.



### 433021 DA 1200 regulation set for 2 inlets

DA 1200 reg.set f. two inlets at different heights.

A pull rod row for each row of inlets is preferred and using 433021 should therefore be regarded as a cheaper alternative.

One for each inlet in the upper row.



### 413214 LPV door set for pull rod Ø8

If there are doors or the like in the wall where the inlets are mounted and you temporarily want to end the pull rod, a special kit containing the necessary parts can be acquired. The kit makes it possible to manually maintain correct ventilation level and easily re-establish the pull rod.

One per door.



### 413223 Door set for wire tension

The mounting set is used where the pull rod is directed along the door frame by means of wire and reels.

One per door.

## DA 1911 flange inlet



### 433174 DA 1900 inlet cover

DA 1900 inlet cover can be used together with the inlets of the DA 1900 series.

The inlet cover is designed to protect the livestock house against rain/snow and to provide a certain amount of wind and light dimming effect.

One per wall inlet.



### 433313 DA 1900 light trap for inlet cover

DA 1900 light trap for inlet is always used together with DA 1900 inlet cover.

The light trap hinders a great deal of daylight from entering the building ("brown out"). The light trap is made of injection-moulded PP (polypropylene) which is dirt-repellent and easy to clean.

Use one for each DA 1900 inlet cover.

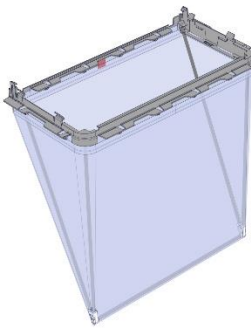

### 433335 DA 1911 fly screen

DA 1911 fly screen for inlet cover is always used together with DA 1900 inlet cover.

The fly screen prevents the ingress of flies and the DA 1200 fly screen is self-supporting.

Can only be used for inlets in one row.

With regular and sufficient cleaning, the capacity of the inlet is not reduced by the use of the fly screen.

1 unit per inlet.



### 433139 DA 1911 hen net, hinged

The bird net prevents the fledged hens from sitting in the air inlet. The net is top-hinged, allowing easy access when servicing the inlet.

The screw kit (560333) must be ordered separately.



### 560333 Screw kit DA 1200/1911 hen net

The screw kit is used to assemble the bird net.

One set per bird net.



### 3 Technical data

DA 1911 flange inlet				
Output at 10 Pa	Wall thickness [cm]			
	< 10	10-20	>20	
	No attachments [m³/h]	1650	1750	2050
	Inlet cover [m³/h]	1300	1550	1700
	Inlet cover + light trap [m³/h]	1250	1500	1650
	Inlet funnel [m³/h]	2000	1950	2050
Mechanical				
Material	100% recyclable thermoplastic, high-impact material, dimensionally stable and UV stabilized			
Springs	Stainless			
Color – inlet frame	Graphite gray			
Color – inlet flap	Blue			
Color – outside flange	Black			
Color – inlet funnel	Black			
Net opening Coarse net [mm]	62 x 21			
Tensile force [N]	20			
Tensile length [mm]	390			
Environment				
Ambient temperature, operation	-40 to +40 °C (-40 to +104 °F)			
Ambient temperature, storage	-40 to +65°C (-40 to +149°F) - and protected against direct sunlight.			
Ambient humidity, operation [% RH]	0-95			
Shipping				
Dimensions L x H x B [mm]	885 x 325 x 150 + extension			
Weight [kg]	Wall inlet	4.1		
	Extension 20 cm [kg]	0.43		
	Extension 30 cm [kg]	0.63		
	Extension 40 cm [kg]	0.88		
	Outside flange [kg]	1.1		
	Inlet funnel [kg]	0.6		
	DA 1911 fly screen [kg]	1.6		
Number of inlets per pallet [pcs.]	48			

### 3.1 Dimensioned sketch

#### DA 1911 flange inlet

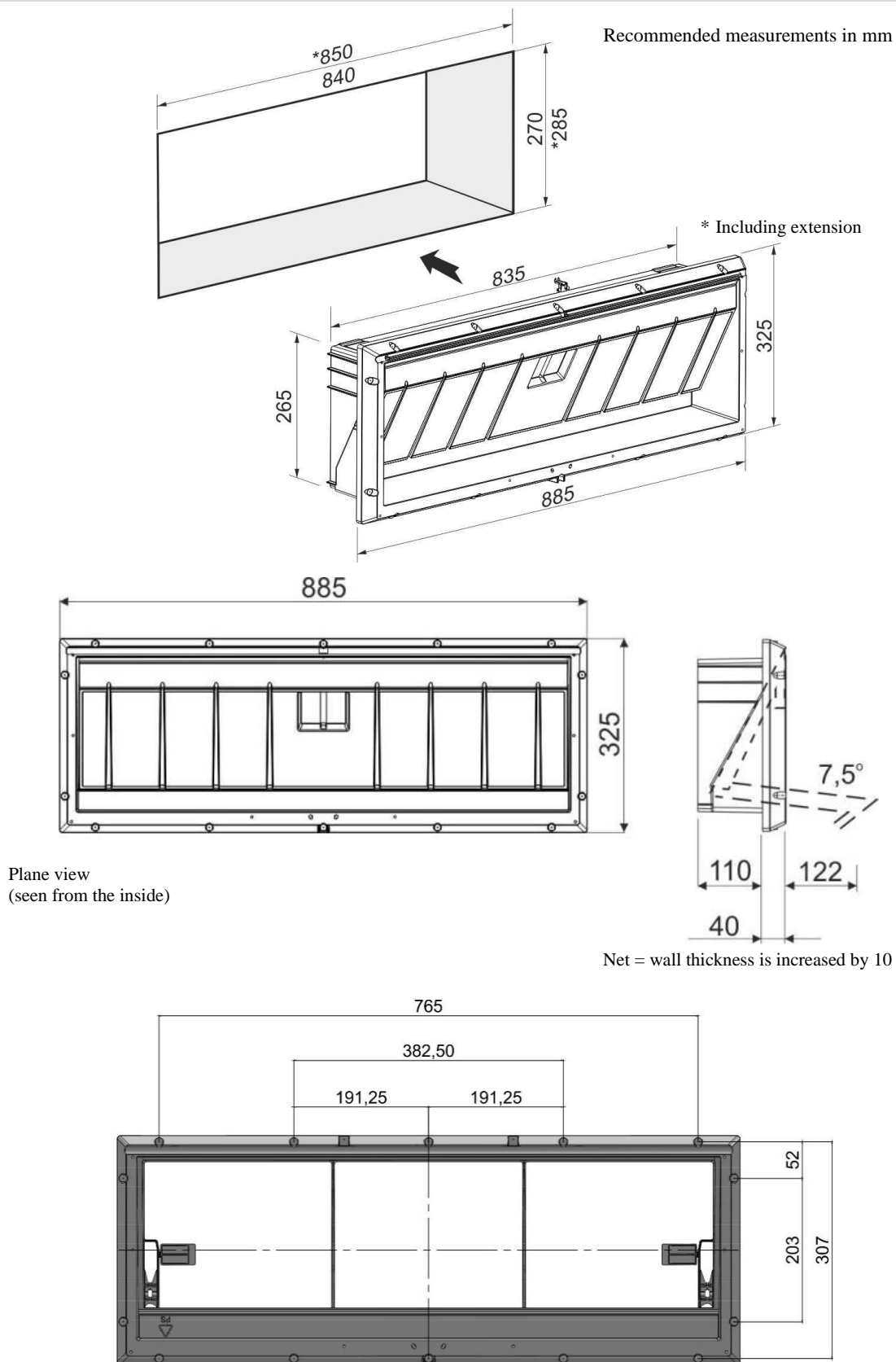



DA 1900 inlet cover

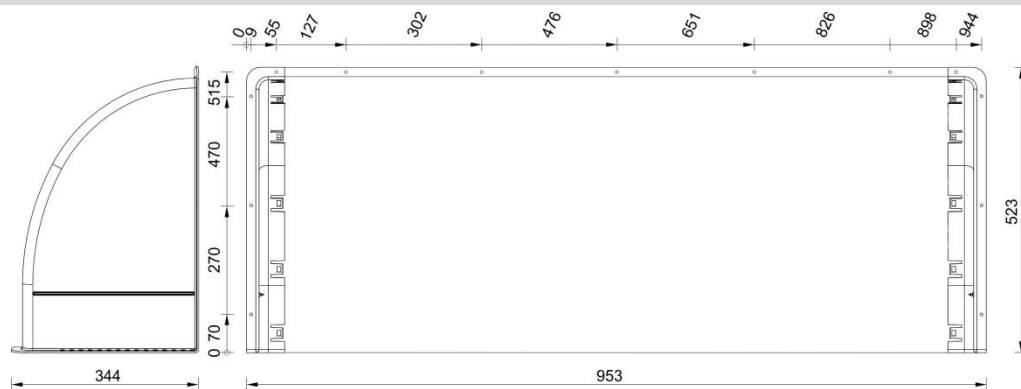

DA 1900 light trap for inlet cover

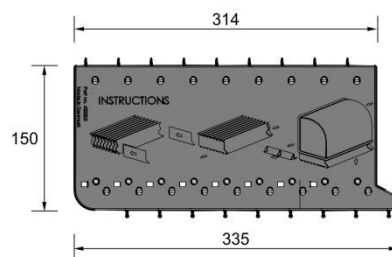
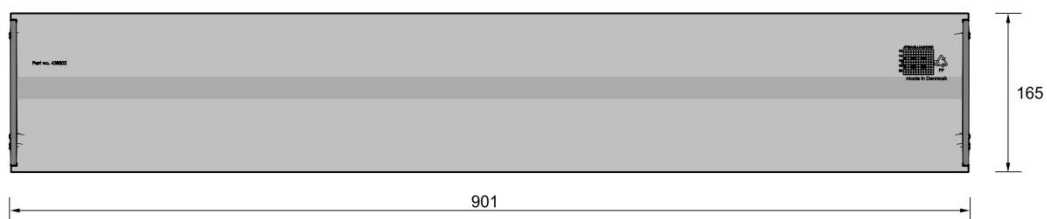
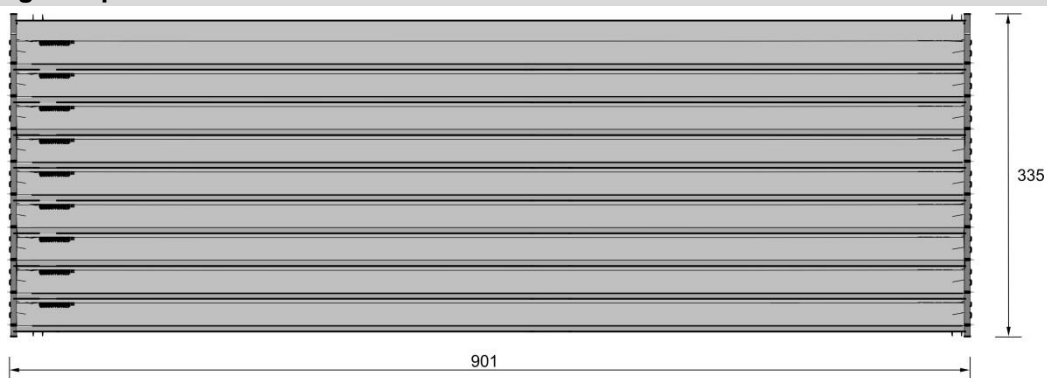

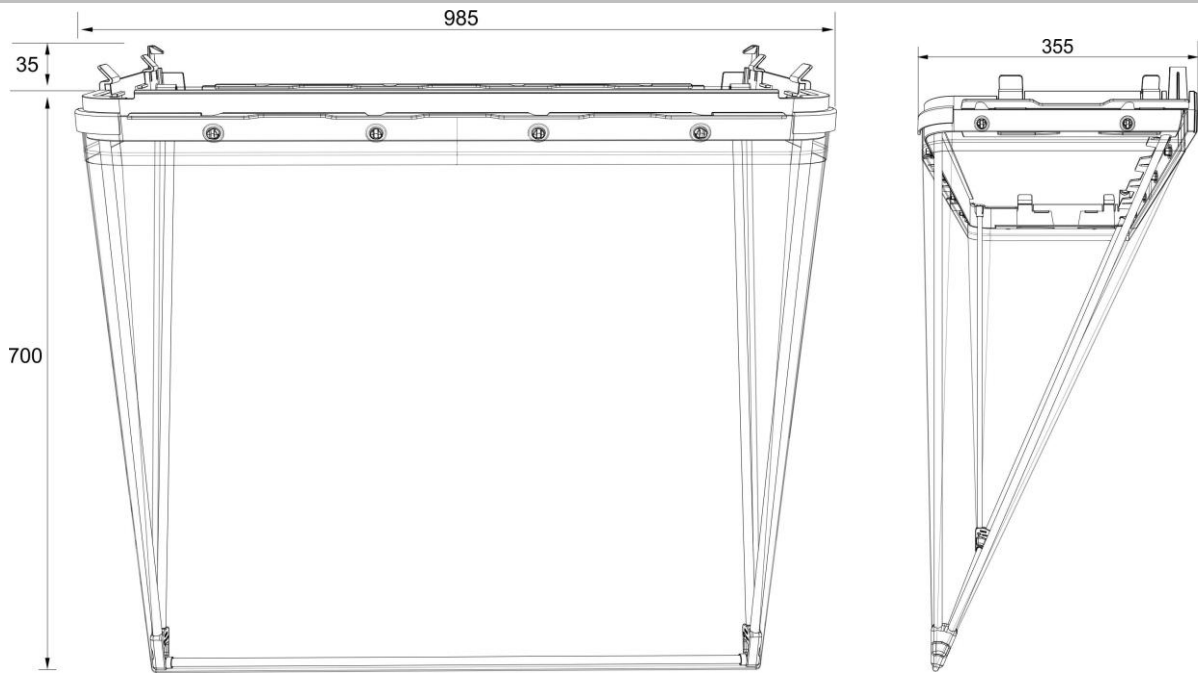
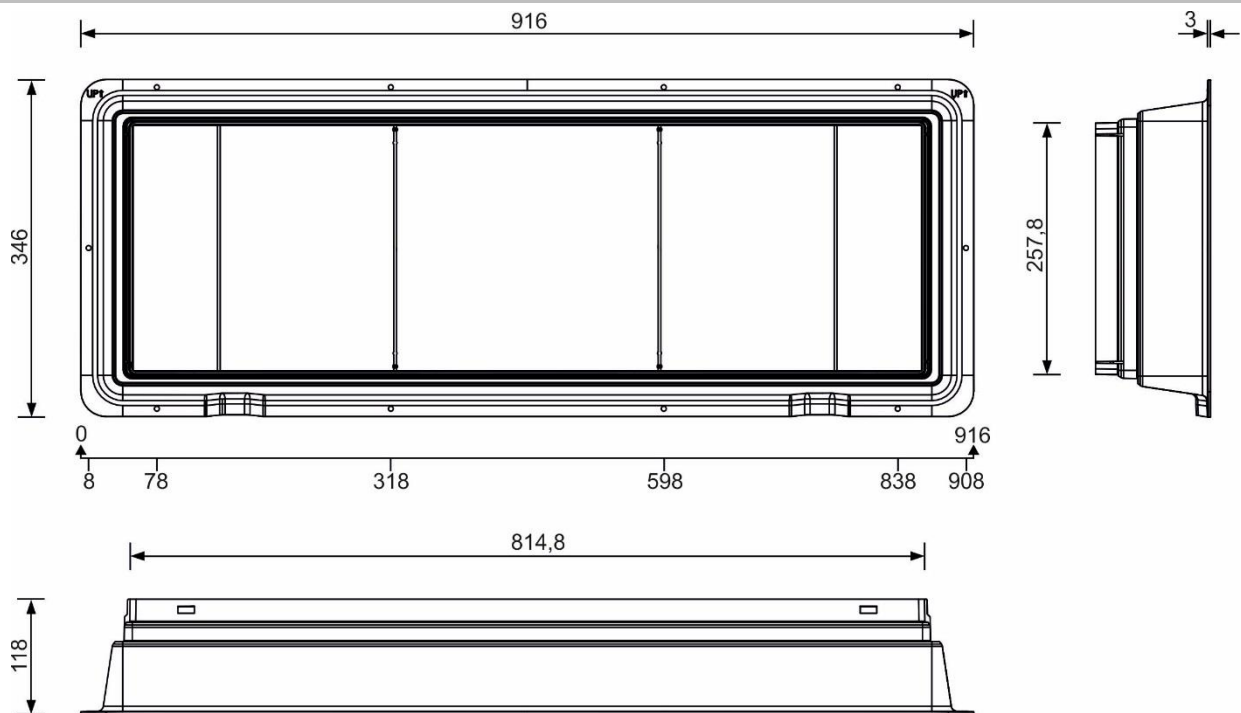
**DA 1911 fly screen****DA 1911 outside flange**

DA 1911 inlet funnel

