

DA 1911 Flange Inlet

Technical Info

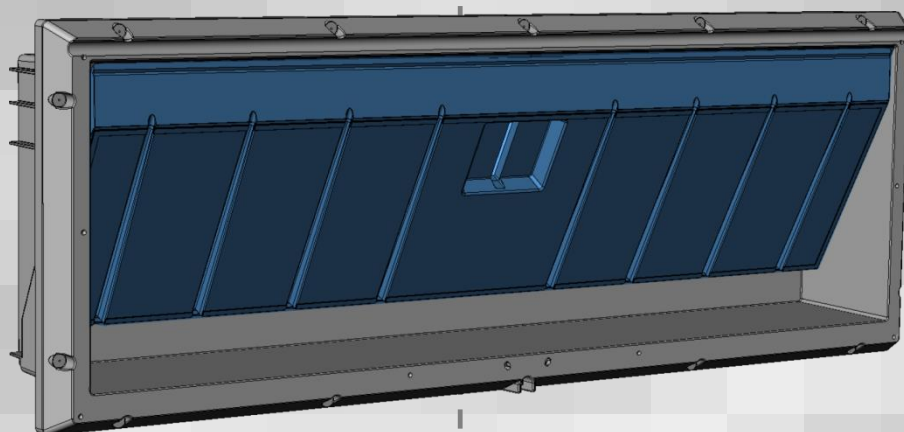

1 Product Description

Flange inlet DA 1911 is a universal wall inlet which is used for ventilating livestock houses with natural, LPV or Combi-Tunnel ventilation.

The flange inlet can be adapted to a wall thickness up to 50cm by means of an extension piece. The inlet is fixed on the inside wall by screws through the flange itself. It cannot be built or cast directly into wall elements.

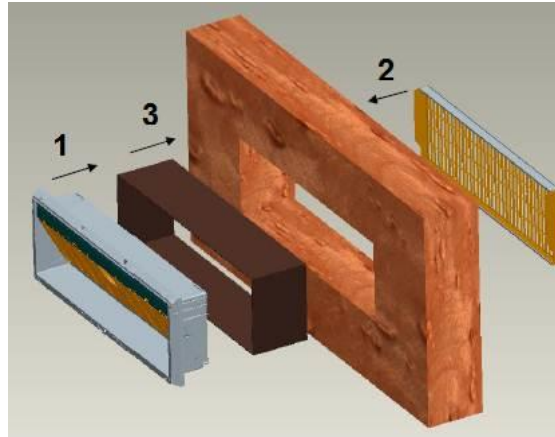

The universal differentiation of the inlets is patent pending and is supplied with a regulation set which makes it easy to adjust the air inlet in accordance with the current conditions.

Accessories

The coarse mesh is an accessory to avoid penetration of birds and larger animals. Furthermore, the following are available: an air direction baffle optimizing the air distribution in the house in periods with cold weather conditions and a wind shield for livestock houses exposed to special wind conditions.

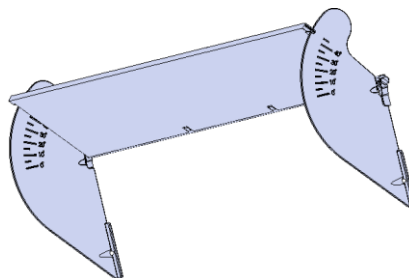

Functional Description

Opening the inlet flap "downwards", it directs the cold fresh air in an upward moving direction. Here the fresh air is mixed with the warm air inside the livestock house before reaching the animal zone. In case of hot weather conditions, the inlet will be in a fully open position.

DA 1911 is easy-to-clean due to its open and smooth construction. Also, the thermoplastic stands high-pressure cleaning. Furthermore, the choice of material makes the inlet resistant to UV radiation. The inlet is made of high-impact material; it is dimensionally stable and 100% recyclable.

2 Product Survey

DA 1911 flange inlet

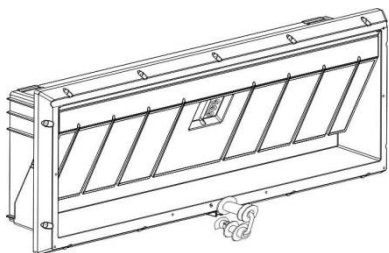

433161 DA 1911 flange inlet 11cm

433161F DA 1911 flange inlet 11cm

433169 DA 1911 flange inlet, 11cm, coarse mesh

Regulation set is included with the flange inlet – the inlet also comes either with or without coarse mesh.

The inlet flap is insulated and the springs are made of stainless steel.

In principle 433161 and 433161F is the same product, however 433161F will be supplied from Thailand.

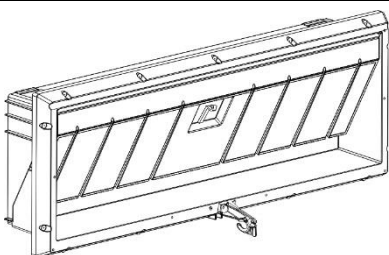

433165 DA 1911B flange inlet 11 cm

433165F DA 1911B flange inlet 11 cm

Regulation set is included with the flange inlet. Advanced inlet control is not possible for DA 1911B.

The inlet flap is not insulated and the springs are electroplated.

In principle 433165 and 433165F is the same product, however 433165F will be supplied from Thailand.

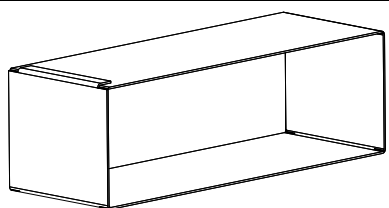

433166 DA 1911 extension piece 20cm

Used for wall dimensions from 12 to 28cm.

433167 DA 1911 extension piece 30 cm

Used for wall dimensions from 17 to 38 cm.

433168 DA 1911 extension piece 40 cm

Used for wall dimensions from 22 to 49 cm.

DA 1911 extension must be used together with the flange inlet when the wall thickness exceeds 11cm.



433164 DA 1911 mesh, coarse 65x20mm

The coarse mesh is used to avoid penetration of birds and larger animals.

One per inlet.



433043 DA 1211/1911 screw kit f. flange, 10/5 set

Used for mounting of DA 1911 flange inlet. Includes 40 4.8x70mm tapping screws.

One set for each five inlets.



433025 DA 1200/1900 screw kit f. net

Is used for fastening of mesh in connection with extension on DA 1911 inlets. Includes the required number of 5 x 30mm stainless screws.

One set for each six inlets.



DA 1911 Flange Inlet

DA 1911 flange inlet

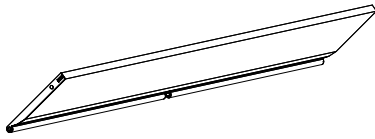

433173 DA 1911 air direction baffle, short

DA 1911 air direction baffle is used to adjust the air jet under cold weather conditions and to avoid adhesion on the wall.

One per inlet.

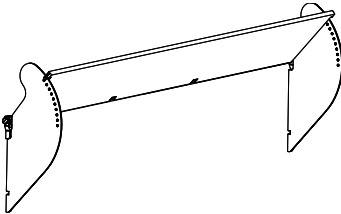

433172 DA 1911 air direction baffle, long w. side plates

DA 1911 air direction baffle is used to adjust the air jet under cold weather conditions and to avoid adhesion on the wall.

Long air direction baffle is mounted with side plates.

One per inlet.



560195 DA 1200 operation set w. long U-shackle

Used where obstacles such as lopsided walls, steel trusses projecting up to 70mm out from the wall, etc. impede the free movement of the pull rod. The current system of differentiation can not be used with the kit and therefore an extra string with spring to reduce the slack is included by which you can make differentiation.

The inlet flap should as a maximum open to a horizontal position; otherwise it may overload the winch motor.

One per inlet.



433039 DA 1200 extension piece 240mm

S433037B DA 1200 extension piece 400mm, type B

Extension rod is used if you want to carry the pull rod round heavy concrete pillars or the like where it is not possible to carry the pull rod directly through the pillar by making a through-going hole. The extension rod is made of stainless steel.

One per inlet.

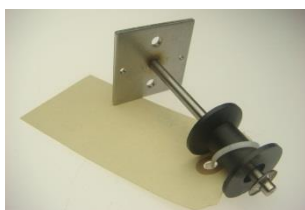

415075 Pulley f. pull rod, flange inlet

Used in connection with flange inlets.

If the distance between the inlets exceeds approx 2m, the pull rod will bend downwards causing inaccuracies if carrier rollers are not used.

One unit for each 2 metres free-hanging pull rod.



433021 DA 1200 regulation set for 2 inlets

DA 1200 reg.set f. two inlets at different heights.

A pull rod row for each row of inlets is preferred and using 433021 should therefore be regarded as a cheaper alternative.

One for each inlet in the upper row.

DA 1911 flange inlet



413214 LPV door set for pull rod Ø8

If there are doors or the like in the wall where the inlets are mounted and you temporarily want to end the pull rod, a special kit containing the necessary parts can be acquired. The kit makes it possible to manually maintain correct ventilation level and easily re-establish the pull rod.

One per door.



413223 Door set for wire tension

The mounting set is used where the pull rod is directed along the door frame by means of wire and reels.

One per door.

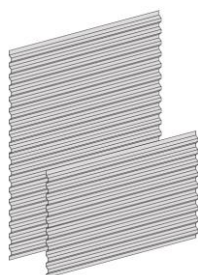

401280 Wind shield f. inlet, 1 row, red

Wind shield for inlet, one row, red, height 550mm.

401281 Wind shield f. inlet, 2 rows, red

Wind shield for inlet, two rows, red, height 1100mm.

Wind shield is used if the livestock house is exposed to wind and if unwanted light encroaches into the livestock house causing disturbance. The wind shield is grey on the inside and red on the outside. Requirement for a different colour is specified on the order and is invoiced as an extra cost.

Ordered by the metre. Max. length per plate is 6m.

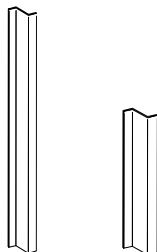

401282 Windshield fitting f. 1 row galv

Windshield and light protection fitting 550mm.

401283 Windshield fitting f. 2 rows galv

Windshield and light protection fitting 1100 mm.

Screws and rawplugs are supplied for mounting of bracket and self-tapping screws for mounting of the wind shield. The brackets ensure a distance to the wall of 150mm.

One 419336 per running two metres.



433174 DA 1900 inlet cover

DA 1900 inlet cover can be used together with the inlets of the DA 1900 series.

The inlet cover is designed to protect the livestock house against rain/snow and to provide a certain amount of wind and light dimming effect.

The output can be dimensioned to 1600 m³/h at 10 Pa and at a wall thickness of 10cm or more.

One per wall inlet.

DA 1911 flange inlet



433313 DA 1900 light trap for inlet cover

DA 1900 light trap for inlet is always used together with DA 1900 inlet cover.

The light trap hinders a great deal of daylight from entering the building ("brown out"). The light trap is made of injection-moulded PP (polypropylene) which is dirt-repellent and easy to clean.

Use one for each DA 1900 inlet cover.

3 Technical Data

DA 1911 flange inlet

Output

Air output at 5 Pa	Coarse mesh (10cm wall) 1250 m ³ /h
Air output at 10 Pa	Coarse mesh (10cm wall) 1750 m ³ /h
Air output at 20 Pa	Coarse mesh (10cm wall) 2500 m ³ /h
Air output at 30 Pa	Coarse mesh (10cm wall) 3050 m ³ /h
Air output at 40 Pa	Coarse mesh (10cm wall) 3550 m ³ /h

Mechanical Setup

Material	100% recyclable thermoplastic, high-impact material, dimensionally stable and UV stabilized
Mesh	Holes 62 x 21mm
Springs	Stainless
Tensile force	20 N
Tensile length	390mm

Environment

Ambient temperature, operation	-40 to +40 °C (-40 to +104°F)
Ambient temperature, storage	-40 to +65 °C (-40 to +149 °F) - and protected against direct solar radiation.
Ambient humidity, operation	0-95 % RH

Shipment

Dimensions L x H x W	885 x 325 x 150 + extension (mm)
Weight	Wall inlet 4.1kg
	Extension 20cm 0.43kg
	Extension 30cm 0.63kg
	Extension 40cm 0.88kg
Number of inlets per pallet	48 pieces

3.1 Dimensioned Sketch

DA 1911 flange inlet

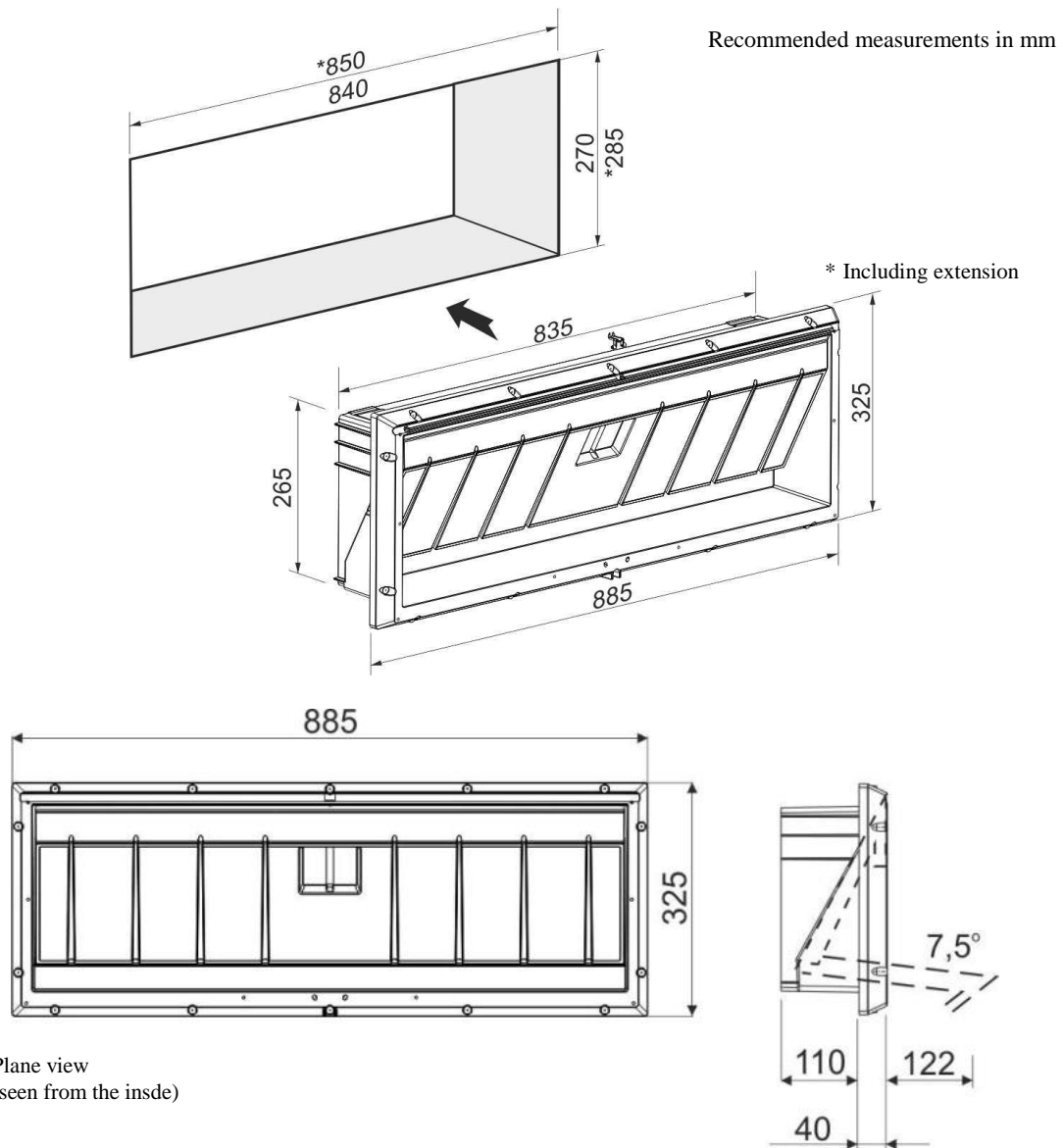

Plane view
(seen from the inside)

Net = wall thickness is increased by 10

DA 1900 inlet cover

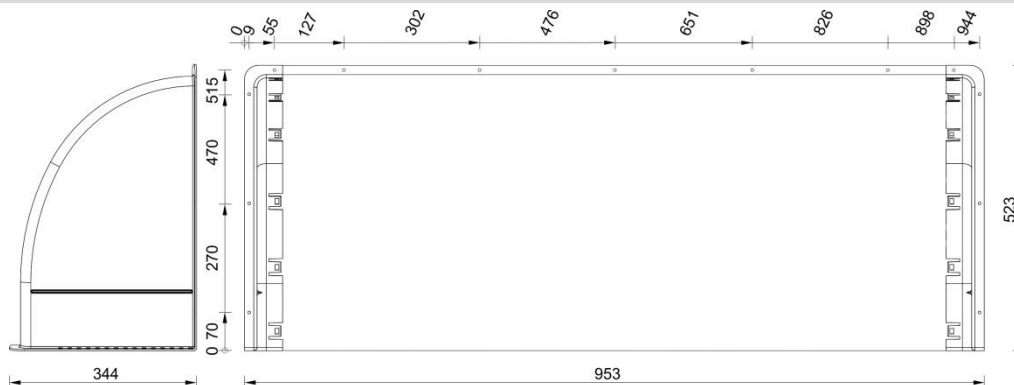

DA 1900 light trap for inlet cover

